

# TTB 160P G ML / TTB 300P W ML WEAR PARTS

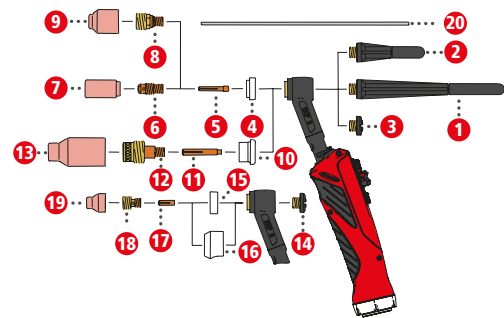

		ARTICLE NUMBER	PG	DC	
<b>TTB 160P G ML / TTB 300P W ML wear parts</b>					
1	*)	44,0350,1495	10	A	Torch cap long L=153
2		44,0350,1496	10	A	Torch cap medium L=64
3		44,0350,1761	10	A	Torch cap short L=11
4		42,0100,0391	10	A	Head shield standard $\phi 20/\phi 10,1 \times 7$
5		42,0001,1129	10	D	Fixing sleeve br. 1.0/ $\phi 4.5 \times 25$
		42,0001,1130	10	A	Fixing sleeve br. 1.6/ $\phi 4.5 \times 25$
	*)	42,0001,1131	10	D	Fixing sleeve br. 2.0/ $\phi 4.5 \times 25$
		42,0001,1132	10	A	Fixing sleeve br. 2.4/ $\phi 4.5 \times 25$
		42,0001,1133	10	A	Fixing sleeve br. 3.2/ $\phi 4.5 \times 25$
6		42,0001,2827	10	A	Clamping sleeve case 1,0/ $\phi 9,5 \times 20,6$
		42,0001,0260	10	A	Clamping sleeve case 1,6/ $\phi 9,5 \times 20,6$
		42,0001,0647	10	D	Fixing sl. case 2.0/ $\phi 9.5 \times 20.6$
	*)	42,0001,0261	10	A	Clamping sleeve case 2,4/ $\phi 9,5 \times 20,6$
		42,0001,0262	10	A	Clamping sleeve case 3,2/ $\phi 9,5 \times 20,6$
7		42,0300,0105	10	A	Gas nozzle ceramic $\phi 6,3/\phi 14,2 \times 29,5$ thread-type
		42,0300,0106	10	A	Gas nozzle ceramic $\phi 8,0/\phi 14,2 \times 29,5$ thread-type
	*)	42,0300,0107	10	A	Gas nozzle ceramic $\phi 9,5/\phi 14 \times 30$ thread-type
		42,0300,0108	10	A	Gas nozzle ceramic $\phi 11,2/\phi 16,2 \times 29,5$ thread-type
		42,0300,0109	10	A	Gas nozzle ceramic $\phi 12,7/\phi 17,6 \times 29,5$ thread-type
		42,0300,0110	10	A	Gas nozzle ceramic $\phi 16/\phi 21 \times 30$ thread-type
<b>Narrow gap gas nozzles</b>					
7		42,1600,0035	10	D	Gas noz ceram $\phi 4.0/\phi 14 \times 48$ scr.
		42,1600,0036	10	D	Gas noz ceram $\phi 6.5/\phi 14 \times 48$ scr.
		42,1600,0037	10	D	Gas noz ceram $\phi 8.0/\phi 14 \times 48$ scr.
		42,1600,0038	10	D	Gas noz ceram $\phi 9.5/\phi 14 \times 48$ scr.
		42,1600,0039	10	D	Gas noz ceram $\phi 4.0/\phi 14 \times 63$ scr.
		42,1600,0040	10	D	Gas noz ceram $\phi 6.5/\phi 14 \times 63$ scr.
		42,1600,0041	10	D	Gas noz ceram $\phi 8.0/\phi 14 \times 63$ scr.
		42,1600,0033	10	D	Gas nozzle ceramic $\phi 6.5/\phi 14 \times 89$ screwable
<b>Standard Gas lens</b>					
4		42,0100,0391	10	A	Head shield standard $\phi 20/\phi 10,1 \times 7$
5		42,0001,1129	10	D	Fixing sleeve br. 1.0/ $\phi 4.5 \times 25$
		42,0001,1130	10	A	Fixing sleeve br. 1.6/ $\phi 4.5 \times 25$
		42,0001,1131	10	D	Fixing sleeve br. 2.0/ $\phi 4.5 \times 25$
		42,0001,1132	10	A	Fixing sleeve br. 2.4/ $\phi 4.5 \times 25$
		42,0001,1133	10	A	Fixing sleeve br. 3.2/ $\phi 4.5 \times 25$
8		42,0001,1343	10	A	Gas lens 1,0/ $\phi 14 \times 22,5$
		42,0001,1344	10	A	Gas lens 1,6/ $\phi 14 \times 22,5$
		42,0001,1135	10	D	Gas lens 2.0/ $\phi 14.1 \times 22$
		42,0001,1345	10	A	Gas lens 2,4/ $\phi 14 \times 22,5$
		42,0001,1346	10	A	Gas lens 3,2/ $\phi 14 \times 22,5$
9		42,0300,0982	10	A	Gas nozzle ceramic $\phi 6,3/\phi 20 \times 25,5$ thread-type
		42,0300,0983	10	A	Gas nozzle ceramic $\phi 8,0/\phi 20 \times 25,5$ thread-type
		42,0300,0984	10	A	Gas nozzle ceramic $\phi 9,5/\phi 20 \times 25,5$ thread-type
		42,0300,2007	10	A	Gas nozzle ceramic $\phi 11,2/\phi 20 \times 25,5$ thread-type
		42,0300,2008	10	A	Gas nozzle ceramic $\phi 12,5/\phi 19 \times 25,5$ thread-type

	ARTICLE NUMBER	PG	DC	
				<b>Gas lens big</b>
10	42,0100,0407	10	A	Head shield big ø30/ø12,8x14
11	42,0001,2826	10	A	Clamping sleeve 1,0/ø5,3x40,2
	42,0001,3001	10	A	Clamping sleeve 1,6/ø5,3x40,2
	42,0001,0570	10	D	Fixing sleeve large 2.0/Ø5x40
	42,0001,3008	10	A	Clamping sleeve 2,4/ø5,3x40,2
	42,0001,3009	10	A	Clamping sleeve 3,2/ø5,3x40,2
12	42,0001,3010	10	A	Gas lens big 1,0/ø25,4x41
	42,0001,3011	10	A	Gas lens big 1,6/ø25,4x41
	42,0001,0571	10	D	Gas lens large 2.0/ø25.4x41
	42,0001,3012	10	A	Gas lens big 2,4/ø25,4x41
	42,0001,3013	10	A	Gas lens big 3,2/ø25,4x41
13	42,0300,2247	10	A	Gas nozzle ceramic ø9,5/ø30,5x48 thread-type
	42,0300,2248	10	A	Gas nozzle ceramic ø12,5/ø30,5x48 thread-type
	42,0300,2249	10	A	Gas nozzle ceramic ø16/ø30,5x48 thread-type
	42,0300,2250	10	A	Gas nozzle ceramic ø19/ø30,5x48 thread-type

				<b>Gas lens small</b>
14	44,0350,1497	10	A	Torch cap short L=11
15	42,0100,0387	10	A	Head shield short ø12/ø20x6
16	42,0100,0388	10	A	Head shield short ø10,1/ø23x16
17	42,0001,3002	10	A	Clamping sleeve 1,0/ø3,2x14
	42,0001,3003	10	A	Clamping sleeve 1,6/ø3,2x14
	42,0001,0681	10	D	Fixing sleeve 2.0/ø3.2x14
	42,0001,3004	10	A	Clamping sleeve 2,4/ø4x13,5
18	44,0350,1489	10	A	Gas lens 1,0/ø11,5x15
	44,0350,1490	10	A	Gas lens 1,6/ø11,5x15
	44,0350,0939	10	D	Gas lens 2.0/ø11.5x15
	44,0350,1491	10	A	Gas lens 2,4/ø11,5x15
19	42,0300,2244	10	A	Gas nozzle ceramic ø6,5/ø16x16 thread-type
	42,0300,2245	10	A	Gas nozzle ceramic ø8/ø16x16 thread-type
	42,0300,2246	10	A	Gas nozzle ceramic ø9,5/ø16x16 thread-type

\* Standard Fittings